

ELECTRIC HANDLE “OUVERTURE EXIT”

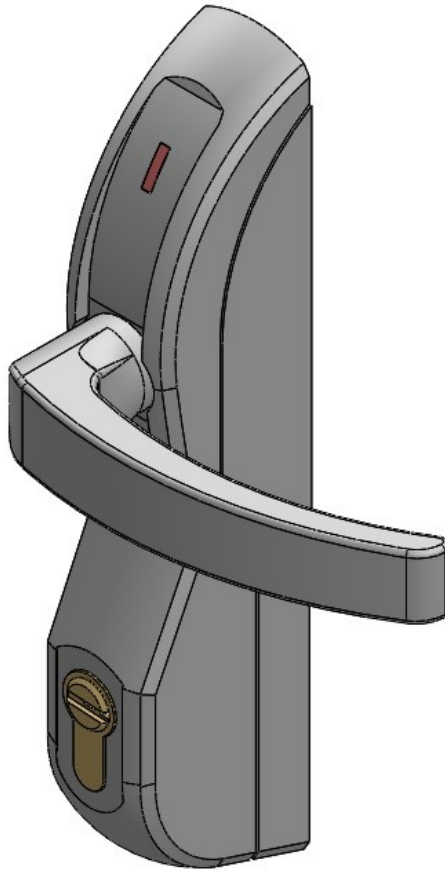

TECHNICAL SPECIFICATIONS

	Art. 40620	Art. 40621	Art. 40820	Art. 40821
OPERATION CONDITION WITHOUT CURRENT	Handle Activated	Handle Activated	Handle Disabled	Handle Disabled
HAND	Non handed	Non handed	Non handed	Non handed
SPINDLE DRIVE	9 mm	9 mm	9 mm	9 mm
SPINDLE DRIVE ROTATION	Adjustable at 45° or 60°	Adjustable at 45° or 60°	Adjustable at 45° or 60°	Adjustable at 45° or 60°
POWER SUPPLY	12 / 24 Vac/dc	12 / 24 Vac/dc	12 / 24 Vac/dc	12 / 24 Vac/dc
START-UP CURRENT (I max)	700 mA	700 mA	700 mA	700 mA
MAINTENANCE CURRENT (I max)	500 mA	500 mA	500 mA	500 mA
TIME DELAY	NO	Adjustable from 0 to 60 seconds	NO	Adjustable from 0 to 60 seconds
EXTERNAL SIGNALING (OPEN COLLECTOR)	NO	YES	NO	YES
WHITE/BLUE LOWER LIGHTING	NO	YES	NO	YES
OPEN RELEASE LEVER	Both electrical and mechanical	Both electrical and mechanical	Both electrical and mechanical	Both electrical and mechanical

The electric handle can be fitted with rim type exit panic devices with visible latch.

The coupling is possible thanks to the fixing plate serie 00428 (to order separately according to the specific bar).

Versions:

- activated without current (Items 40620 – 40621)

It is disabled (handle in neutral position) with power supply

- disabled (handle in neutral position) without current (Items 40820 - 40821)

It is enabled with power supply

Attention: not suitable for outdoor exposure.

INSTALLATION

- Check the bar is correctly installed and the holes for the handle frame and fixing screws are present on the door.

- Insert the handle as shown in the figure and rotate it in the desired direction.

NB: for versions 40620 and 40621 this operation must be performed when power is ON; for versions 40820 and 40821 when power is OFF.

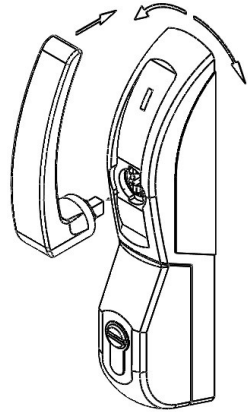

- Fix the handle with the appropriate supplied screw and split washer (Grower).

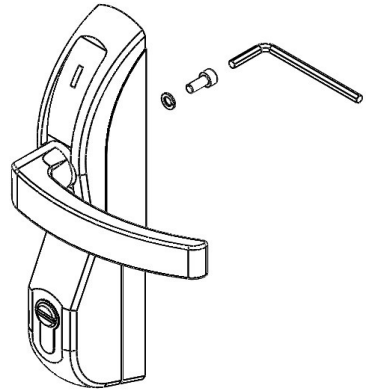

- Before completing the installation, it is necessary to select the rotation of the spindle drive using the appropriate selector on the back of the handle. It can be of 45° or 60°, depending on the bar to fit with the electric handle.

To change the selection, use a flat screwdriver, press and rotate the spindle selector until the cut line up with the desired degrees (see figure). Release the spindle selector in the desired position.

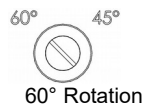
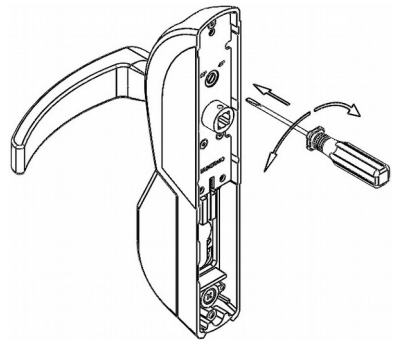

- Using the key, it is possible to mechanically enable the electric handle.
To activate the mechanic open release lever, remove the grub screw that prevents the complete rotation (see figure).
In this configuration, the key enables the permanent mechanical activation of the electric handle. To disconnect the open release lever, use the key manually.

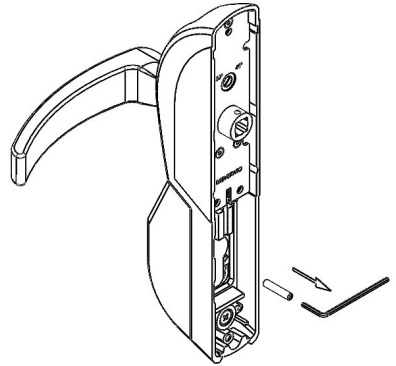

- Fix the back plate with the appropriate screws and make sure the fixing bushes are in the correct position in front of the fixing holes on the bar.

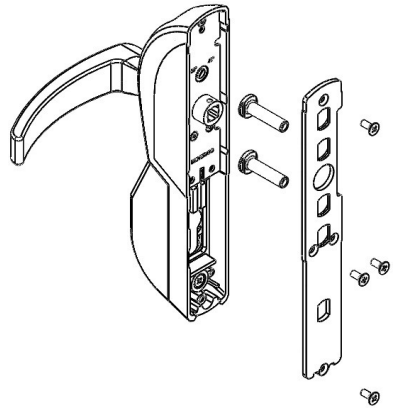

- If one of the fixing bushes is placed to the cylinder height, tighten the supplied nylocks in the back part of the bush (see figure).

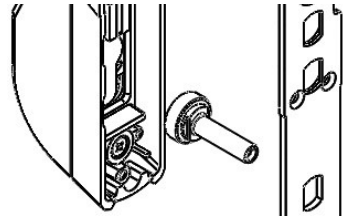

- Reduce the spindle and the fixing screws as per the indications supplied with 00428 instructions

- Block the spindle with the appropriate grub screw only if necessary.

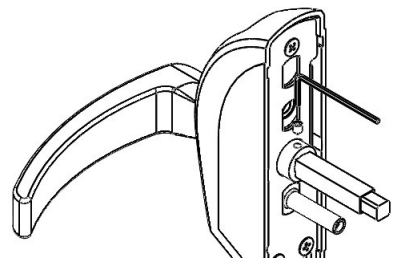

- Tighten the screws previously reduced to complete the installation. Make sure the striking parts are free to move and do not hit parts of the door or obstruct the bar mechanism. Cable has not to be damaged or pressed.

MODE OF OPERATION

Direct activation with power supply (without time delay)

40620 serie

When the electric handle is disabled (in neutral), the red LED is on. Without power, the LED turns off and the handle enables the door opening as long as power is OFF.

40820 serie

When the electric handle is disabled (in neutral), the green LED is off. Power supply enables the door opening and green LED turns on as long as power is ON.

Attention: time delay has to be set at 0 seconds for items code 40621 and 40821.

It is possible to use both the lead cover and the pressure contacts.

Activation with dry contact (with time delay)

40621 – 40821 series

When the electric handle is disabled (in neutral), the red LED is on. Handle enables door opening once the opening switch is pressed and released and the green LED is on for the setted time (from 5 to 60 seconds) or until the first activation of the handle.

To reopen the door, the opening swicth has to be pressed again.

The use of a lead cover si recommended.

TIME DELAY CONFIGURATION

(Only for 40621 – 40821 versions)

The electric handle has a time delay system inside which enables to keep the handle enabled for the time selected by the user.

Time delay configuration at 0 seconds

1. Connect the N.O. programming switch (not included) to the blue wire and to the green wire of the ground signals.
2. Connect the handle to the power supply (grey and white wires).
3. Plate has a red LED light. Press the programming switch until the LED becomes blue. Release the programming switch immediately. LED turns on for about one second to confirm programming. Electric handle remains enabled for the duration of the electrical pulse only.

Time delay configuration from 5 to 60 seconds

1. Connect the N.O. programming switch (not included) to the blue wire and to the green wire of the ground signals (GND).
2. Connect the handle to the power supply (grey and white wires).
3. Plate has a red LED light. Press the programming switch until the LED becomes blue. Keep the switch pressed and the LED double flashes, each flash corresponding to 5 seconds. Once the desired timing is achieved, release the programming switch. LED confirms set timing flashing. Electric handle remains enabled for the selected time or until the first activation.

ELECTRIC HOLD OPEN DEVICE

To keep the door enabled for a time set by the user, it is necessary to install a switch in parallel with the opening switch. It will keep the door open until its disconnection.

ACTIVATION AND DEACTIVATION OF THE LOWER WHITE/BLUE LED'S LIGHTING

(40621 – 40821 versions only)

Electric handle serie 40621 and 40821 has a blue (electric handle disabled) and a white LED (electric handle activated) on the lower part which create a light beam near the floor.

White/blue LED's deactivation

1. Connect the N.O. programming switch (not included) to the blue and to the green wire of the ground signals (GND).
2. Press the programming switch when the electric handle is deactivated.
3. Connect the handle to the power supply, keeping the switch pressed.
4. Blue LED light will flash twice and it will then become red. Releasing the programming switch, LED will flash twice confirming the white/blue lower lighting deactivation.

White/blue LED's activation

1. Connect the N.O. programming switch (not included) to the blue and to the green wire of the ground signals (GND).
2. Press the programming switch when the electric handle is deactivated.
3. Connect the handle to the power supply, keeping the switch pressed.
4. Blue LED light will flash twice and it will then become red. Releasing the programming switch, LED will flash twice confirming the white/blue lower lighting activation.

CYLINDER REPLACEMENT

- Unscrew the cylinder locking screw

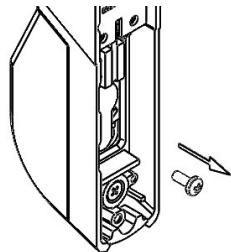

- Pull the cylinder out

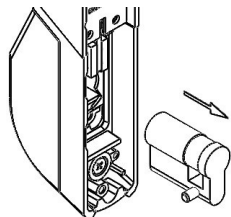

- Move the grub screw from the old to the new cylinder

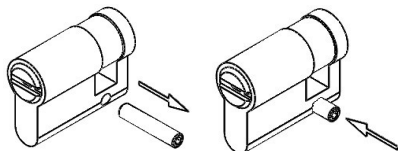

- Insert the cylinder back again

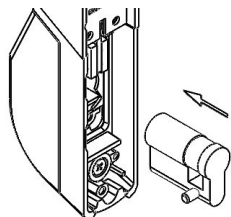

- Tighten the cylinder locking screws

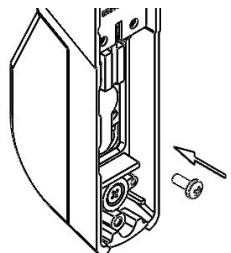

- The electric handle is suitable for a Euro profile half cylinder
Cylinder length = 40mm (30+10)

INSTALLATION EXAMPLES

Electric handle with Push-Bar.

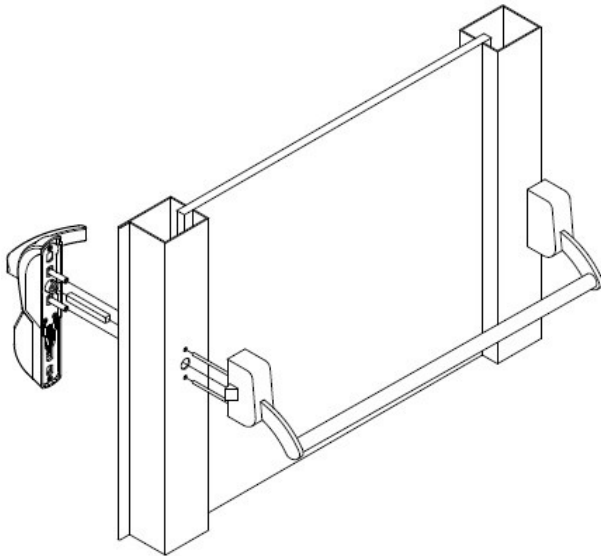

Electric handle with Touch-Bar.

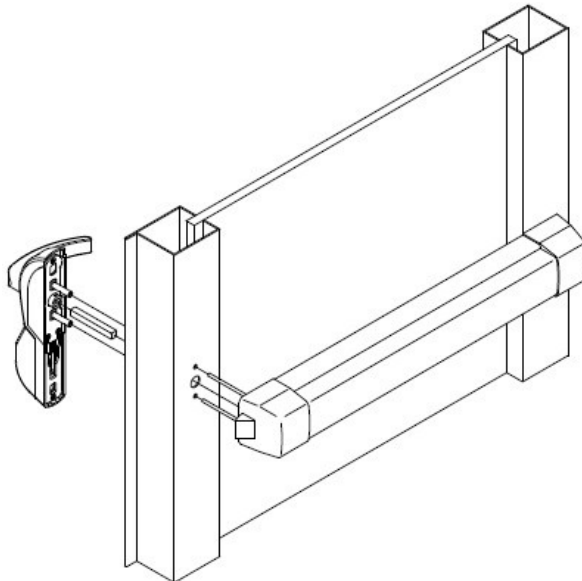

CONNECTING DIAGRAM

**“DC” power supply with direct electricity activation
for items 40620 – 40621* – 40820 - 40821***

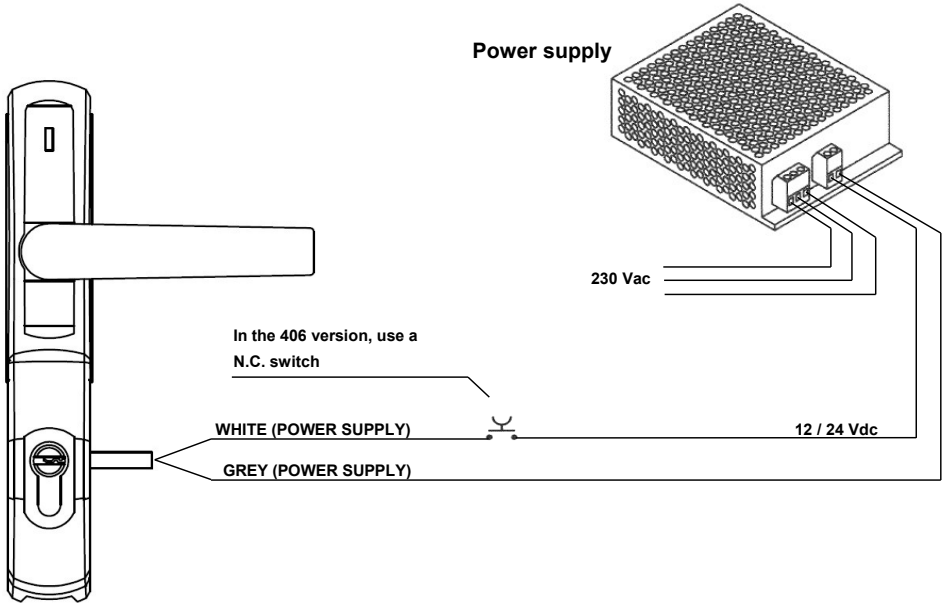

**“AC” power supply with direct electricity activation
for items 40620 – 40621* – 40820 - 40821***

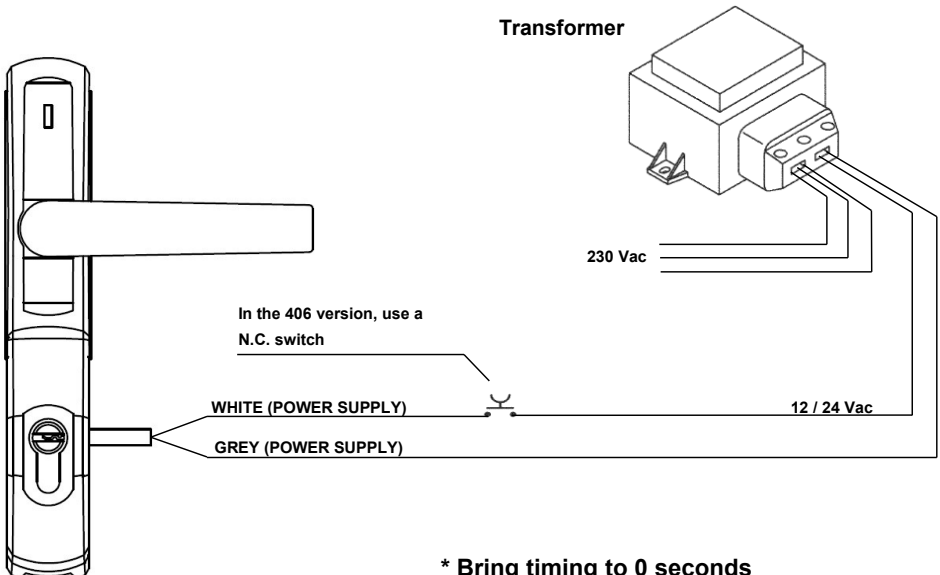

*** Bring timing to 0 seconds**

**“DC” power supply and opening by contact
for items 40621 - 40821**

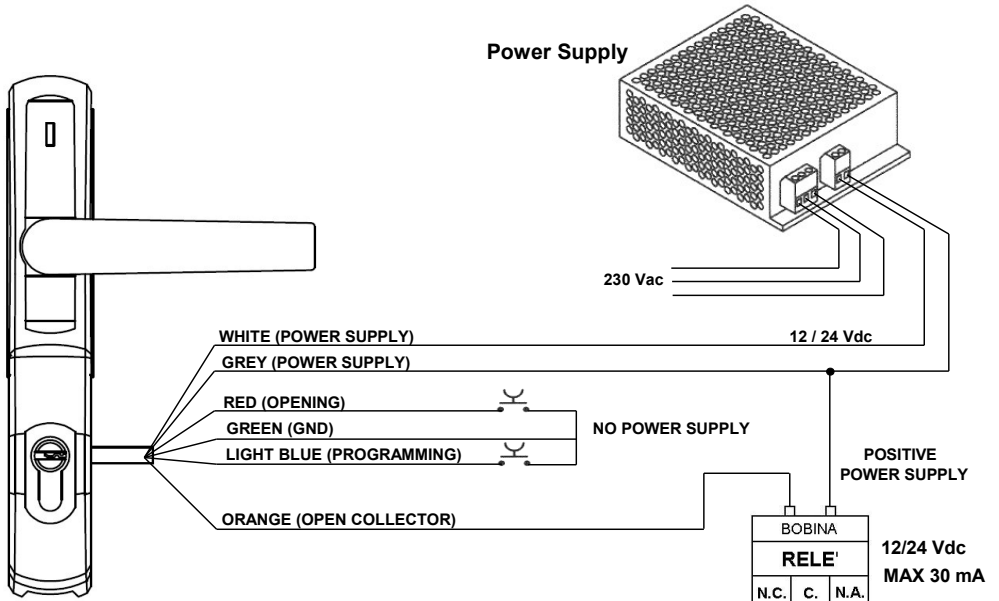

**“AC” power supply and opening by contact
for items 40621 - 40821**

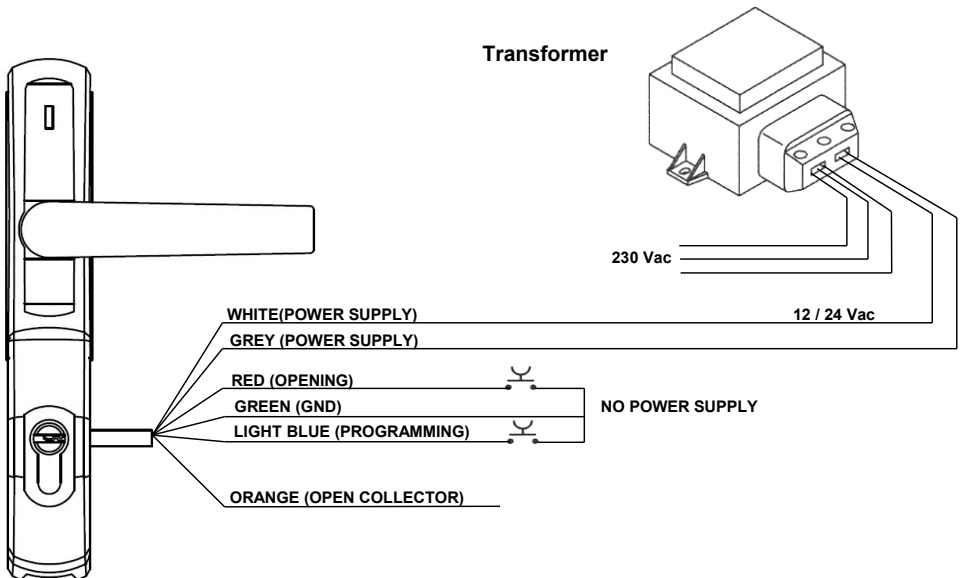

Intercom electric handle connection

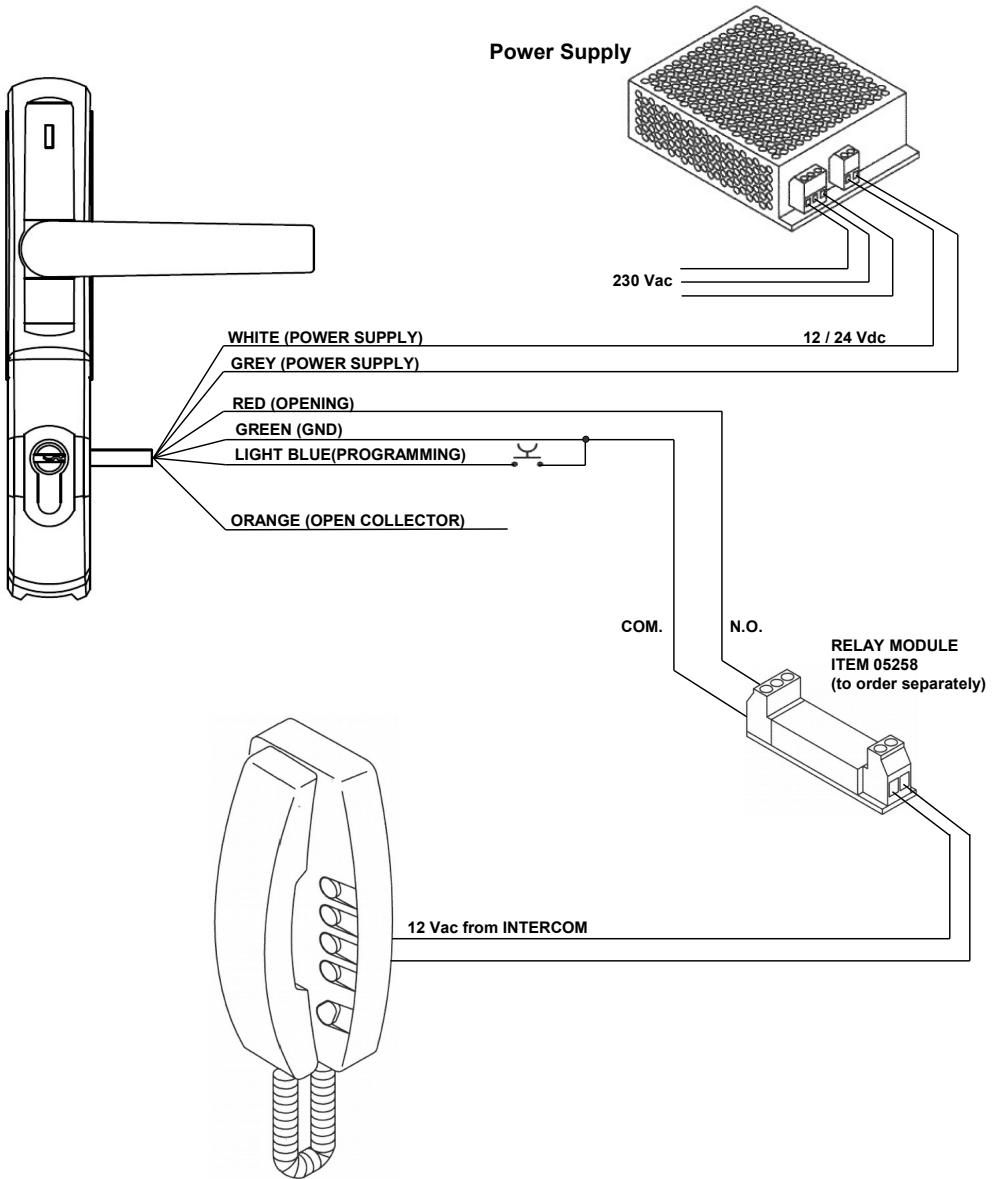

OPERA s.r.l.

Tel. 059 451708

www.opera-italy.com – info@opera-access.it